



# SPARE PARTS

## FOR LIFT UNITS

### Extended pallet support

Extended pallet support for lift unit LARGE

ART.NO	DESCRIPTION
3000106	Right
3000107	Left

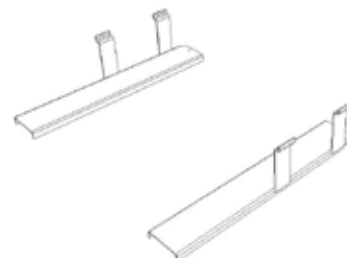

3000106 & 3000107

### Extended support

Extended support for roll container LARGE

ARTNR	DESCRIPTION
3000358	Right
3000359	Left

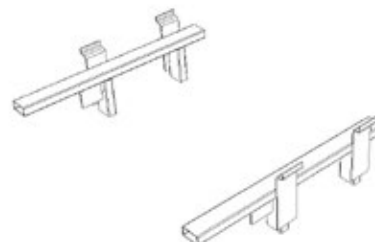

3000358 & 3000359

## FOR HOODS

### Limit switch FR531

2100002

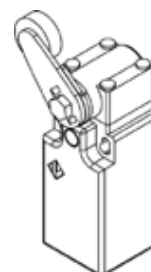

2100002

### Gas absorber for hood

Each hood uses two gas absorbers. Sold individually.

1000040

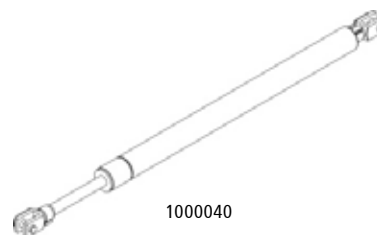

1000040

# FOR TABLES

## Wheel

Wheel for tables incl. M8 screw. Each table uses four wheels. Sold individually.

-1000027

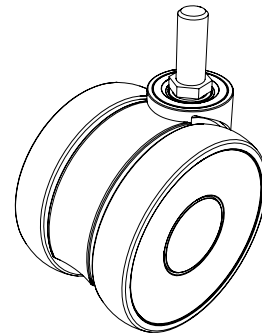

-1000027

## Stabilizing wheels

Stabilizing wheel for tables equipped with top. Comes in pairs.

-5600020

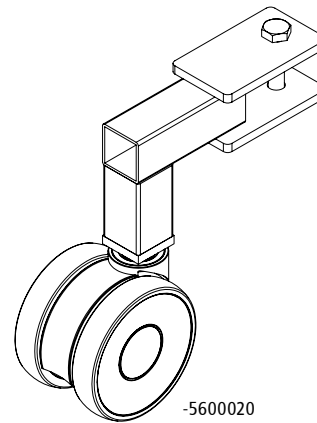

-5600020

## Rubber strap

Each table uses two rubber straps. Sold individually.

1000078

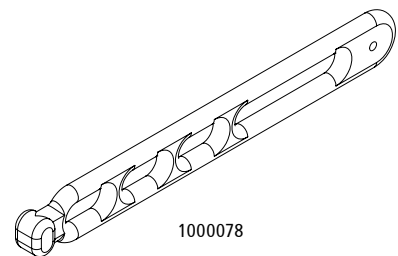

1000078

## Bracket for rubber straps

One bracket for each rubber strap. Each table uses two rubber straps. Sold individually.

-1000012



-1000012

## Plastic bag holder

Plastic bag holder in stainless steel. Each table is equipped with two holders. Sold individually.

ART.NO	DESCRIPTION
5600224-H	Right
5600224-V	Left



5600224-H

## Rubber list, complete

Complete rubber list for tables LARGE incl. seven screws, nuts and washers.

**3000063**

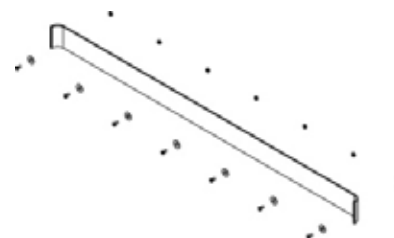

3000063

# MACHINERY

## Sprockets for drive shaft

Each lift unit uses two sprockets. Sold individually. Delivered with wedge and stop screw.

5100028

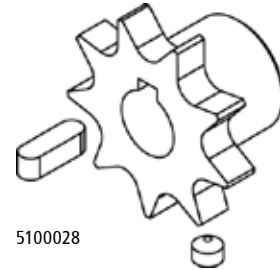

5100028

## Chain adjuster, complete

Complete kit for adjusting drive chain incl. adjuster, screws washers, rubber disk, 5600064, circlip and nut. Each lift unit uses two chain adjusters.

-5600063

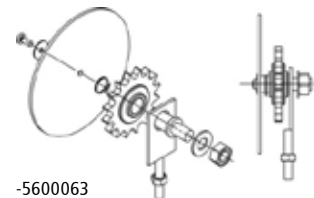

-5600063

## Spocket mounting kit, complete

Complete kit for mounting spocket incl. circlip, protective plate, 5600065, washer and nut. Each lift unit uses four spocket mounting kits.

-5600064

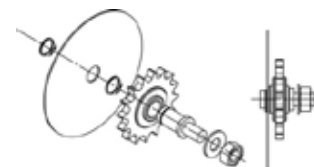

-5600064

## Spocket and pin

Each lift unit uses six spockets and pins

5600065

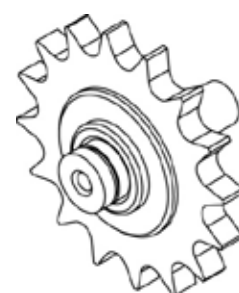

5600065

## ELECTRONICS FOR LIFT UNITS

### Limit switch FR531

-2100002

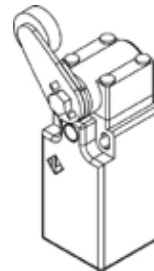

2100002

### Rotary switch with text 1-0-2, complete

2100039

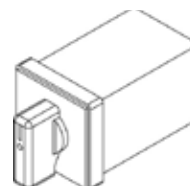

2100039

### Limit switch for hatch or door

Limit switch for door or hatch. Used when lift unit is placed in an external wooden cabinet.

2100090

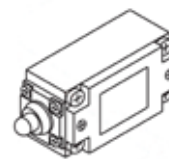

2100090

### Reset button

2100009

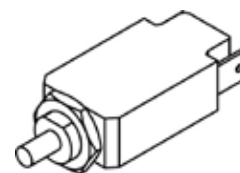

2100009

### Emergency, complete

2100017

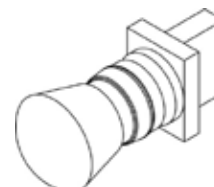

2100017

# CONTACT INFORMATION



Susanne Pettersson  
Quality Manager  
Tel: +46 19-689 45 40  
Mob: +46 70-101 08 06

## CONCEPT MANAGER



Johan Särefors  
Head of Export  
Tel: +46 19-689 45 09  
Mob: +46 70-101 64 22

## SALES TEAM SWEDEN



Pär Andersson  
Sales  
Tel: +46 19-689 45 21  
Mob: +46 70-191 20 43



Klemens Oscarsson  
Sales  
Tel: +46 19-689 45 13  
Mob: +46 70-100 12 04

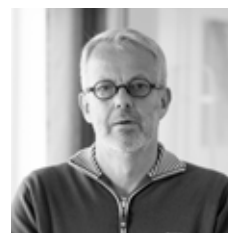

Peter Berglund  
Sales  
Tel: +46 19-689 45 24  
Mob: +46 70-191 20 46

**A NATION OF  
POTATO LOVERS  
CAN'T BE WRONG**



**BUTIKSKONSULT**

**Address:** Järsjögatan 9 **Mail:** Box 140, 692 23 KUMLA, Sweden  
**Office:** 019-57 80 80 **Email:** [inredning@butikskonsult.com](mailto:inredning@butikskonsult.com) **Web:** [www.butikskonsult.com](http://www.butikskonsult.com)