



SPARE PARTS

FOR LIFT UNITS

Extended pallet support

Extended pallet support for lift unit LARGE

ART.NO	DESCRIPTION
3000106	Right
3000107	Left

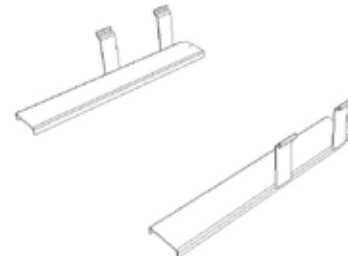

3000106 & 3000107

Extended support

Extended support for roll container LARGE

ARTNR	DESCRIPTION
3000358	Right
3000359	Left

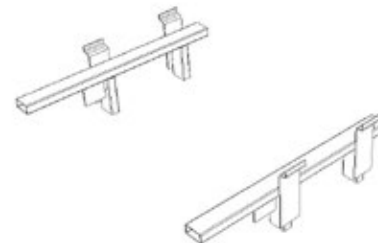

3000358 & 3000359

FOR HOODS

Limit switch FR531

2100002

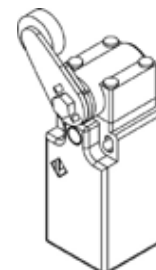

2100002

Gas absorber for hood

Each hood uses two gas absorbers. Sold individually.

1000040

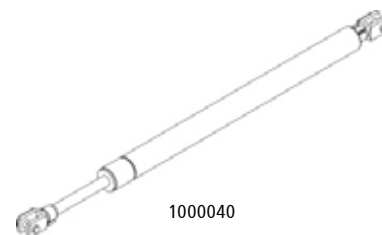

1000040

FOR TABLES

Wheel

Wheel for tables incl. M8 screw. Each table uses four wheels. Sold individually.

-1000027

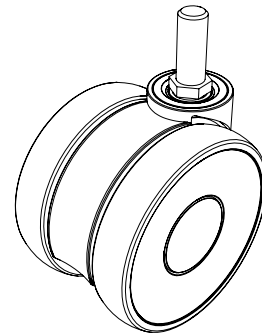

-1000027

Stabilizing wheels

Stabilizing wheel for tables equipped with top. Comes in pairs.

-5600020

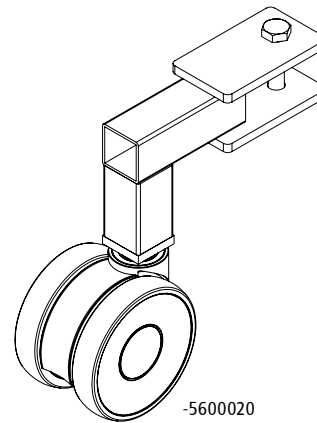

-5600020

Rubber strap

Each table uses two rubber straps. Sold individually.

1000078

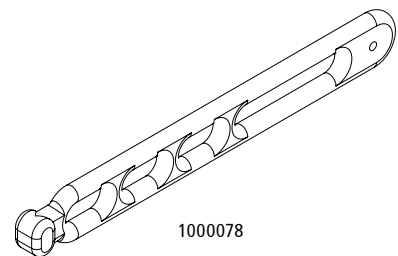

1000078

Bracket for rubber straps

One bracket for each rubber strap. Each table uses two rubber straps. Sold individually.

-1000012



-1000012

Plastic bag holder

Plastic bag holder in stainless steel. Each table is equipped with two holders. Sold individually.

ART.NO	DESCRIPTION
5600224-H	Right
5600224-V	Left



5600224-H

Rubber list, complete

Complete rubber list for tables LARGE incl. seven screws, nuts and washers.

3000063

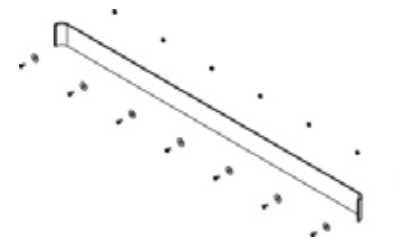

3000063

MACHINERY

Sprockets for drive shaft

Each lift unit uses two sprockets. Sold individually. Delivered with wedge and stop screw.

5100028

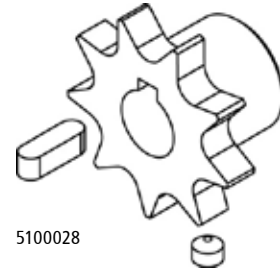

5100028

Chain adjuster, complete

Complete kit for adjusting drive chain incl. adjuster, screws washers, rubber disk, 5600064, circlip and nut. Each lift unit uses two chain adjusters.

-5600063

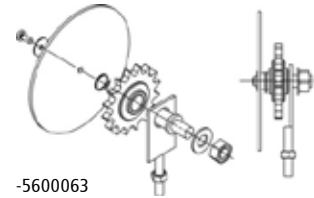

-5600063

Spocket mounting kit, complete

Complete kit for mounting spocket incl. circlip, protective plate, 5600065, washer and nut. Each lift unit uses four spocket mounting kits.

-5600064

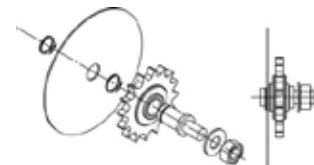

-5600064

Spocket and pin

Each lift unit uses six spockets and pins

5600065

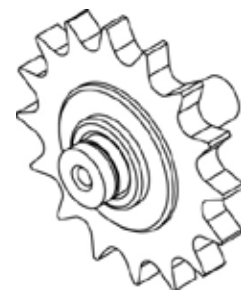

5600065

ELECTRONICS FOR LIFT UNITS

Limit switch FR531

-2100002

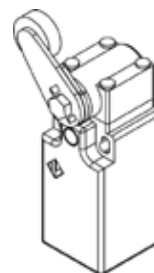

2100002

Rotary switch with text 1-0-2, complete

2100039

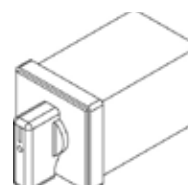

2100039

Limit switch for hatch or door

Limit switch for door or hatch. Used when lift unit is placed in an external wooden cabinet.

2100090

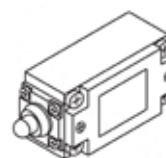

2100090

Reset button

2100009

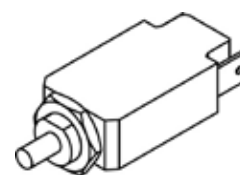

2100009

Emergency, complete

2100017

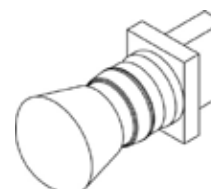

2100017

CONTACT INFORMATION



Susanne Pettersson
Quality Manager
Tel: +46 19-689 45 40
Mob: +46 70-101 08 06

CONCEPT MANAGER



Mathias Fermby
KAM Export
Tel: +46 19-277 28 25
Mob: +46 70-229 47 39

SALES TEAM SWEDEN



Pär Andersson
Sales
Tel: +46 19-689 45 21
Mob: +46 70-191 20 43



Klemens Oscarsson
Sales
Tel: +46 19-689 45 13
Mob: +46 70-100 12 04

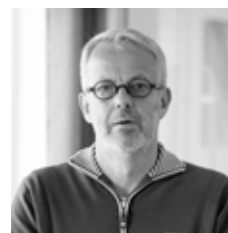

Peter Berglund
Sales
Tel: +46 19-689 45 24
Mob: +46 70-191 20 46

**A NATION OF
POTATO LOVERS
CAN'T BE WRONG**



BUTIKSKONSULT

Address: Järsjögatan 9 **Mail:** Box 140, 692 23 KUMLA, Sweden
Office: 019-57 80 80 **Email:** inredning@butikskonsult.com **Web:** www.butikskonsult.com